

TECHNICAL DATA SHEET

PRODUCT DESCRIPTION

Nippon Paint Alkali Guard Primer is a water-based penetrating Primer for concrete, masonry and lime-based surfaces. The product penetrates below the substrate's surface and blocks free lime coming on to the surface. It acts as an anchor between the surface and the top-coat. It also enhances efflorescence resistant property thereby protects the structure for longer period. It also improves water resistance and very good alkali resistance to exterior masonry surface.



GREEN ASSURED



PRODUCT FEATURES & BENEFITS



Alkali Resistant
Protects the paint film from alkali attack for longer-lasting walls.



Anti Chalking
Minimizes surface chalking to maintain a clean and fresh appearance



Strong Adhesion & Durability
Ensures strong bonding and long-lasting performance on interior surfaces.



Excellent Coverage
Provides superior hiding power for better coverage with fewer coats.



Low VOC
Environment friendly and healthy paint

TECHNICAL DETAILS

Bases	:	White	
Finish	:	Smooth	
Dry Time	:	To Touch: 30 minutes	To Recoat: 4-6 hours
Clean up solvent	:	Clean, potable water	
Stability of diluted paint	:	24 Hours	
Shelf life:		5 Years from the date of manufacture in original tightly closed containers.	
Dilution	:	Upto 100% with clean Potable water by Volume.	
Stir & Strain well before use.			

Coverage

9.3 – 11.2 sq.m/Litre (Actual coverage is dependent on the substrate condition, surface porosity, and method of application.)



HOW TO APPLY

Surface Preparation

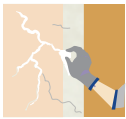

For Repainting: Clean the surface till it is free from dust, grease and flaking paint from surface. Any unstable paint to be removed, using high pressure wash or scraper whichever is appropriate. Algae and fungus on the wall to be removed, by using high pressure wash or coir brush and shall be treated with Walltron Kleanwall fungicidal solution.

New plaster/Fresh Concrete: Ensure surface is completely cured and dry. Application of cement paint/lime/Cement putty as undercoat is not recommended. Fill the cracks upto 3mm if any with Walltron N-Seal Crack Fill Powder.

Application

Brush:	Dilute with water 100% for Exterior use
Roller:	Dilute with water 100% for Exterior Use
Conventional Spray:	Dilute with water 40% - 50% for Exterior use

Application Area

To be applied on exterior Concrete, Masonry, Fiber Cement board, Gypsum Boards & Puttied surface.

Process

For Exterior Surfaces

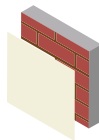

Primer
Nippon Paint
Alkali Block Primer

 Apply 1 coat

 Allow it to dry for 4-5 hours

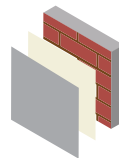

Top Coat
Nippon Paint
Exterior Emulsion
Top coat

Apply 2-3 coats

Allow it to dry for 4-6 hours

SAFETY HEALTH & ENVIRONMENTAL INFORMATION

During Painting:

- Always work in a well ventilated area.
- Wear appropriate attire, especially gloves and eye protection gear.
- Avoid contact with skin as it may cause irritation.

Cleaning:

Clean all equipments with clean water immediately after use.

Safety Instructions:

- In the case of eye contact, rinse immediately with water and seek immediate medical treatment.
- To remove paint from skin, use soap and water or appropriate cleanser.
- In the event of spillage, contain and collect spilt paint by using sand or earth.

Precautions:

- Do not apply during rains or extreme temperatures.
- Avoid painting when the temperature is below 10°C and above 45°C. Relative humidity should be below 85%.
- Do not keep unpainted for more than 15 days.
- The moisture content of the walls should be below 16% (measured by Protimeter) and the alkalinity of the wall should be below pH-9.
- For highly affected areas by Efflorescence, two coats of Alkali Guard Primer is recommended followed by topcoats.
- Primer applied surface must be top coated immediately after proper drying.

Storage:

- Store paint in a cool, dry and well ventilated place away from heat sources, flammables or direct sunlight.
- Keep container tightly closed in a secure, upright position.
- Do not store near food, drink or animal feed.
- Keep out of reach of children.
- Do not dispose of unwanted paint into drains, water sources or open sewers.
- To dispose safely, pour unwanted paint onto old newspapers and let dry before placing in a proper waste receptacle.

Environment:

- Does not contain any added lead, mercury or chromium compounds.

Lead content does not exceed 90 parts per million.

Disposal Information:

Disposal of any paint waste and containers in accordance with applicable Environment (Protection) Act 1986 under Hazardous & Other Wastes (Management and Transboundary Movement) Rules, 2016.

Safety data sheets will be made available to professional users upon request



Contact Us

Registered Office : NIPPON PAINT (INDIA) PRIVATE LIMITED

Plot No. K-8(I), Phase-II, SIPCOT Industrial Park, Mambakkam Village, Sriperumbudur, Singuvarchatiram, Kancheepuram - 602 106, Tamil Nadu, India.