



**NIPPON
PAINT**

MELAMIC
Interior Wood Finish

Nippon Paint Melamic is a specially-formulated, solvent-based, two-pack transparent wood finish for interiors. Its superior low-odour formulation not only protects wood and veneers from scratches and stains but also enhances its aesthetics.

GREEN ASSURED



PRODUCT FEATURES



Lowodour

Its special low-odour formulation makes the application process comfortable for the user.



Lead-free

Paints that do not contain heavy metals are safe to use at home and are environment-friendly too.



High Scratch resistance

It forms a very strong layer that provides resistance against scratches that occur during normal maintenance.





NIPPON PAINT

MELAMIC

Interior Wood Finish

TECHNICAL DETAILS

Bases and colours	:	N.A.
Colour range	:	Clear coat
Finish	:	Glossy & Matt
Dry time	:	To Touch: 30 Minutes To Re-coat: 4 - 6 Hours
Gloss level	:	60° head, 79 - 85 Units
Clean-up solvent	:	Nippon Paint Melamic Thinner
Mixing Ratio	:	9:1
Stability of diluted paint	:	24 hours
Shelf life	:	2 Years from the date of manufacture in original tightly-closed containers
Dilution	:	Up to 20 - 25% by volume using Nippon Paint Melamic Thinner only

Coverage:



MELAMIC

10 - 12 m² /litre/coat

(Actual coverage is depends on the type of wood and surface preparation)

HOW TO APPLY

Surface Preparation:



Ensure the surface is clean, dry and free from oil and wax before application. Smoothen the surface using Emery paper 180 followed by Emery paper 320. If necessary, fill the wood grains with appropriate filler and then smoothen with Emery paper 320. For re-painting, remove all unstable paint film, dust, oil, wax and other foreign particles before application.

Process:

Wood surfaces

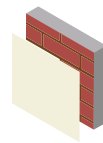

Sealer
Nippon Paint
Melamic Sealer

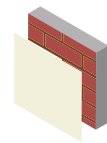

Top Coat
Nippon Paint Melamic

Application:

Brush	:	Dilute all glossy, matt and sealer with 10 - 15% by volume using Nippon Paint Melamic Thinner
Roller	:	N.A.
Conventional spray	:	Dilute all glossy, matt and sealer with 20 - 25% by volume using Nippon paint Melamic Thinner



Apply 2-3 coat



Allow it to dry
for 16 hours



Apply 2-3 coat



Allow it to dry
for 6-8 hours

SAFETY AND ENVIRONMENT

During Painting:

Always work in a well ventilated area. Wear appropriate attire, especially gloves and eye protection gear. Avoid contact with skin as it may cause irritation.

Cleaning:

Cleaning all tools with GP Thinner or Melamic Thinner.

Safety Instructions:

In the case of eye contact, rinse immediately with water and seek immediate medical treatment. To remove paint from skin, use soap and water or appropriate cleanser. In the event of spillage, contain and collect spilt paint by using sand or earth.

Precautions:

Avoid painting when the temperature is below 10°C. Painting is not recommended If the moisture content is high. Moisture content of the wood should be below 16%.

Storage:

Store paint in a cool, dry and well ventilated place away from heat sources, flammables or direct sunlight. Keep container tightly closed in a secure, upright position. Do not store near food, drink or animal feed. Keep out of reach of children. Do not dispose of unwanted paint into drains, water sources or open sewers. To dispose safely, pour unwanted paint onto old newspapers and let dry before placing in a proper waste receptacle

Disposal Information:

Disposal of any paint waste & containers in accordance with applicable Environment (Protection) Act 1986 under the Hazardous Wastes (Management & Handling) rules 1989.

Environment:

Does not contain any added lead, mercury or chromium compounds.
Lead content does not exceed 90 parts per million.

