



**NIPPON  
PAINT**

**CLEARTONE**  
PU Wood Finish

Nippon Clearton Exterior PU Wood Finish is a clear two pack polyurethane finish which protects the wood & maintains its natural beauty. It comes in gloss & matt finishes for all kinds of interior, exterior wood & veneers. Clearton's tough film ensures no scratches and stain on the wood. The acid & alkali resistant property protects the surface from household cleansers keeping the surface stain free. Its unique formulation ensures that the film stays clear so that the wood grain looks beautiful for long.

## GREEN ASSURED



## PRODUCT FEATURES

### Excellent protection against weathering/tough environment

Wood gets protected from yellowing and stains.





# NIPPON PAINT

# CLEARTONE

## PU Wood Finish

## TECHNICAL DETAILS

Bases	:	Nippon Paint Cleartone Sealer, Nippon Paint Cleartone Glossy & Nippon Paint Cleartone Matt
Colour Range	:	NA
Finish	:	New cleartone Interior Sealer, Matt & Glossy Cleartone Exterior Sealer, Matt & Glossy
Dry Time	:	Surface dry: 45 Mts, Tack Free: 2 Hours   To Recoat: 8 Hours   Hard dry: 16 Hours
Gloss level	:	Glossy: 60° head, 85-91 units, Matt: 60° head, 20-25 units
Clean up solvent	:	Nippon Cleartone Thinner
Mixing Ratio	:	4:1
Stability of diluted paint	:	4-5 Hours
Pot Life	:	3.5 Hours
Shelf life	:	2 Years
Dilution	:	Upto 25-30% Nippon Cleartone Thinner

## Coverage:



### CLEARTONE

Square feet 100-110 Sq. Ft./ Ltr/ Coat

(Actual coverage is depends on the type of wooden substrates)

## HOW TO APPLY

### Surface Preparation:



Remove flakes of old paint or powdery residues by sanding using sand paper. Surface must be free from dirt, grease, oil and other foreign substances

### Application:

Brush: N.A.

Roller: N.A.

Conventional spray: Up to 25-30% with Nippon Paint Cleartone Thinner

## Process:

### Wood surfaces

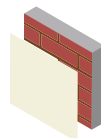

**Sealer**  
Nippon Paint  
Cleartone Sealer



Apply 2-3 coat



Allow it to dry  
for 16 hours

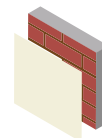

**Top Coat**  
Nippon Paint Cleartone  
Glossy /Nippon Paint  
Cleartone Matt



Apply 2 coat



Allow it to dry  
for 16 hours

## SAFETY AND ENVIRONMENT

### During Painting:

Always work in a well ventilated area. Wear appropriate attire, especially gloves and eye protection gear. Avoid contact with skin as it may cause irritation.

### Cleaning:

Clean all the tools with GP thinner or Cleartone thinner

### Safety Instructions:

In the case of eye contact, rinse immediately with water and seek immediate medical treatment. To remove paint from skin, use soap and water or appropriate cleanser. In the event of spillage, contain and collect spilt paint by using sand or earth.

### Precautions:

Avoid painting when the temperature is below 10°C. Painting is not recommended. If the moisture content of the wood should be below 16%.

### Storage:

Store paint in a cool, dry and well ventilated place away from heat sources, flammables or direct sunlight. Keep container tightly closed in a secure, upright position. Do not store near food, drink or animal feed. Keep out of reach of children. Do not dispose of unwanted paint into drains, water sources or open sewers. To dispose safely, pour unwanted paint onto old newspapers and let dry before placing in a proper waste receptacle

### Disposal Information:

Disposal of any paint waste & containers in accordance with applicable Environment (Protection) Act 1986 under the Hazardous Wastes (Management & Handling) rules 1989.

### Environment:

Does not contain any added lead, mercury or chromium compounds.

**Lead content does not exceed 90 parts per million.**

